

PCD7.L66D-MC52T

Multi-sensor

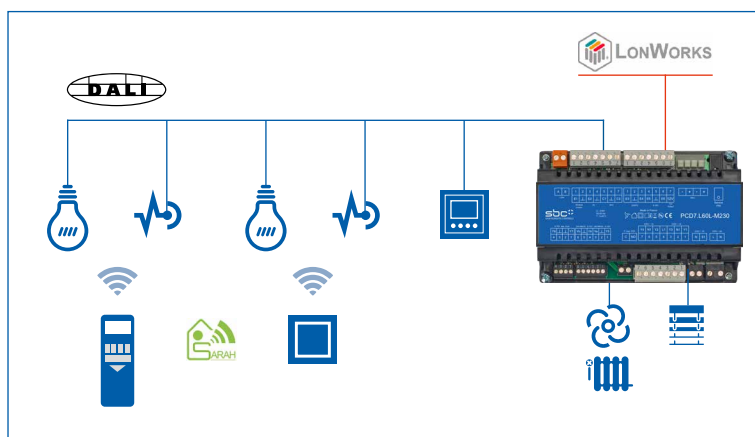

The SBC multi-sensor can be used to adapt the comfort level in a building based on room occupancy (motion detection) and adapt the light intensity, according to the photometric sensors. Both these parameters can be set with our multi-purpose remote control or the CVC.



Key advantages

- ▶ sensors/receivers in a single product
- ▶ open communication protocols: DALI, SARAH
- ▶ the power is supplied through DALI (no additional power supply required)
- ▶ several multi-sensors on a single controller

In a single unit, designed to be installed in the ceiling, the MC multi-sensor combines a SARAH RF receiver/transmitter, a motion detector and an ambient photometric sensor.

It is connected to a controller from the SBC line using a DALI bus with 2 wires, to:

- ▶ transmit commands received from the RF remote to the controller
- ▶ measure the luminosity and process the information received from the motion detector

Functions

- ▶ Communicating sensors: presence, luminosity and transmission/reception of SARAH RF signals
- ▶ Presence detector "slight motion" (detection of small movements)
- ▶ Measurement of luminosity from 0 to 1000 Lux
- ▶ Optional 2 MC multi-sensors on a single controller (2 basic ones and up to 4 max on request) using a DALI-SBC bus (automatic setting of different multi-sensors through this bus during power-up)
- ▶ Power supply by 2 DALI wires (communication DALI-SBC)
- ▶ Discrete installation is achieved due to the white polycarbonate V0 material of the casing

Mechanical characteristics

Material	Polycarbonate V0
Colour	White
Dimensions of visible parts	Ø 50 mm × 5 mm
Dimensions when inserted	Ø 32 mm × 30 mm
Overall dimensions	Ø 50 mm × 35 mm

Photometric sensor

Type	Photo-diode
Amplitude	0 to 1000 lux

Standards/Warranties

DIRECTIVE 2014/35/EU "LOW VOLTAGE"
DIRECTIVE 2011/65/EU "ROHS DIRECTIVE"
DIRECTIVE 2014/30/EU "ELECTROMAGNETIC COMPATIBILITY"

Installation

Ceiling installation with standard spring fittings (provided) or with M32 nut (optional). Installation on the ceiling. Position the multi-sensors so that the axis between the presence detector and the photometric hole is parallel to the window.

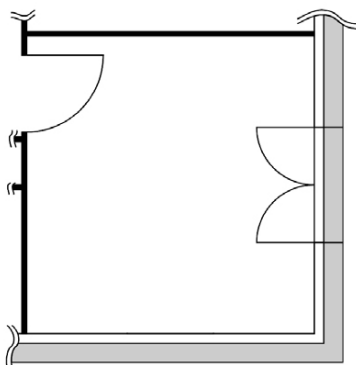

Electrical specifications

Feed voltage of the DALI network: Max 15 V
Consumption < 0.2 W

Environment

Operating temperature 5°C to +45°C
Storage temperature -20°C to +70°C

Motion detector

Optical Fresnel 16-face lens
Type Passive quadruple infrared components

Detection distance 5.80 m maximum
Detection speed 0.5 m/s to 1.5 m/s

Minimum temperature difference between the target and the environment: 4°C

Axial detection zone : 3.60 m to 2.50 m in height

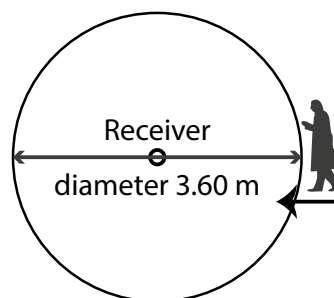

Tangent detection zone : 5.80 m to 2.50 m high

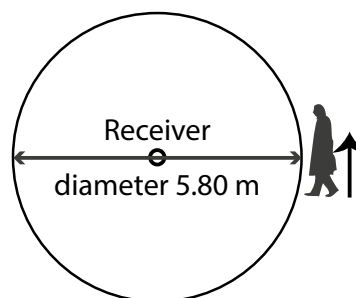

Saia-Burgess Controls AG

Bahnhofstrasse 18 | 3280 Murten, Switzerland
T +41 26 580 30 00 | F +41 26 580 34 99
www.saia-pcd.com

support@saia-pcd.com | www.sbc-support.com