

Saia PCD7.D23x Release Note



Do not touch any electronic part on the board! Handle the product with care (grounding strap) to avoid any Electrostatic Discharge. Some components can be damaged if this occurs.

This system is developed according to the international standard EN/IEC61131-2:2003 for controller and complies with CE conformity and Shipping Approval Norms (DetNorske Veritas, etc... details on request).

<p>UL Compliance</p>  <p>According to the following conditions</p>	<p>Conformité UL selon les conditions suivantes</p>
<p>For use on a Flat Surface of a Type 1 Enclosure.</p>	<p>Pour une utilisation sur une surface plane de « Enclosure Type 1 ».</p>
<p>Use 60/75°C copper (CU) wire only.</p>	<p>N'utiliser que des fils de cuivre, isolation 60/75°C.</p>
<p>Caution: do not connect directly to line voltage. Line voltage must be supplied by a suitable, approved 24 VDC isolating transformer having short circuit capacity not exceeding 100 VA maximum and with secondary protected by a 4 A UL248 listed fuse“.</p>	<p>Attention: ne pas connecter directement à la tension de ligne. La tension de ligne conforme 24 VDC doit provenir d'un transformateur isolé approuvé ayant une capacité de court-circuit ne dépassant pas 100 VA maximum et dont le secondaire est protégée par un fusible 4 A UL248 classé.</p>
<p>This device is suitable for use in a 55 degrees C max ambient.</p>	<p>Ce dispositif est adapté pour une utilisation dans une ambiante de 55 degrés C max.</p>

Certificates

	<p>EAC Mark of Conformity for Machinery Exports to Russia, Kazakhstan or Belarus</p>
--	--

Connectors' view

Power supply (X2)

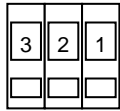

PGND
GND
24VDC

Communication (X1)



The Standard D-Sub 9-pin female is fitted

Pins are as following:

- | | |
|-----------------------------|--|
| Pin 1 : RXD_422 | Pin 6 : /RXD_422 |
| Pin 2 : TxD_232 | Pin 7 : CTS_232 |
| Pin 3 : RxD_232 | Pin 8 : RTS_232 |
| Pin 4 : TXD_422 / TX-RX_485 | Pin 9 : /TXD_422 / /TX-/RX_485 |
| Pin 5 : SGND | <i>Metal support connected to PGND</i> |

All unused pins must be disconnected!

Cut-out dimensions

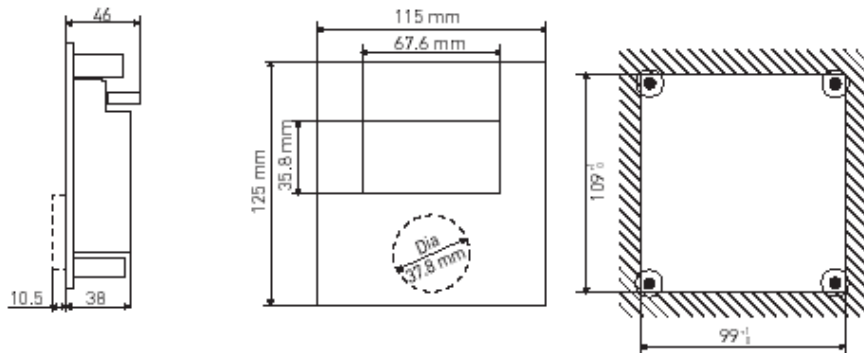

Further information and support

Further information and Software/COSinus-Updates are available on www.sbc-support.com

Disclaimer

The plant engineer contributes his share to the reliable operation of an installation. He is responsible for ensuring that controller use conforms to the technical data and that no excessive stresses are placed on it, e.g. with regard to temperature ranges, over voltages and noise fields or mechanical stresses. In addition, the plant engineer is also responsible for ensuring that a faulty product in no case leads to personal injury or even death, nor to the damage or destruction of property. The relevant safety regulations must always be observed. Dangerous faults must be recognized by additional measures and any consequences prevented. Consistent use of the diagnostic elements of the PCD, such as the watchdog, exception organization blocks (XOB) and test or diagnostic instructions shall be made.

Saia PCD7.D23x Release Note



Do not touch any electronic part on the board! Handle the product with care (grounding strap) to avoid any Electrostatic Discharge. Some components can be damaged if this occurs.

This system is developed according to the international standard EN/IEC61131-2:2003 for controller and complies with CE conformity and Shipping Approval Norms (DetNorske Veritas, etc... details on request).

<p>UL Compliance</p> <p>According to the following conditions</p> <p>For use on a Flat Surface of a Type 1 Enclosure.</p> <p>Use 60/75°C copper (CU) wire only.</p> <p>Caution: do not connect directly to line voltage. Line voltage must be supplied by a suitable, approved 24 VDC isolating transformer having short circuit capacity not exceeding 100 VA maximum and with secondary protected by a 4 A UL248 listed fuse“.</p> <p>This device is suitable for use in a 55 degrees C max ambient.</p>	<p>Conformité UL selon les conditions suivantes</p> <p>Pour une utilisation sur une surface plane de « Enclosure Type 1 ».</p> <p>N'utiliser que des fils de cuivre, isolation 60/75°C.</p> <p>Attention: ne pas connecter directement à la tension de ligne. La tension de ligne conforme 24 VDC doit provenir d'un transformateur isolé approuvé ayant une capacité de court-circuit ne dépassant pas 100 VA maximum et dont le secondaire est protégée par un fusible 4 A UL248 classé.</p> <p>Ce dispositif est adapté pour une utilisation dans une ambiante de 55 degrés C max.</p>
--	--

Certificates

	EAC Mark of Conformity for Machinery Exports to Russia, Kazakhstan or Belarus
--	---

Connectors' view

Power supply (X2)

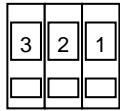

PGND
GND
24VDC

Communication (X1)



9 8 7 6

The Standard D-Sub 9-pin female is fitted

Pins are as following:

- | | |
|-----------------------------|--|
| Pin 1 : RXD_422 | Pin 6 : /RXD_422 |
| Pin 2 : TxD_232 | Pin 7 : CTS_232 |
| Pin 3 : RxD_232 | Pin 8 : RTS_232 |
| Pin 4 : TXD_422 / TX-RX_485 | Pin 9 : /TXD_422 / /TX-/RX_485 |
| Pin 5 : SGND | <i>Metal support connected to PGND</i> |

All unused pins must be disconnected!

Cut-out dimensions

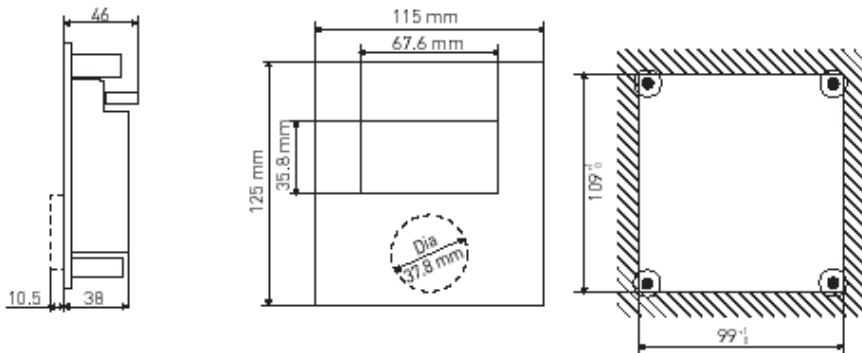

Further information and support

Further information and Software/COSinus-Updates are available on www.sbc-support.com

Disclaimer

The plant engineer contributes his share to the reliable operation of an installation. He is responsible for ensuring that controller use conforms to the technical data and that no excessive stresses are placed on it, e.g. with regard to temperature ranges, over voltages and noise fields or mechanical stresses. In addition, the plant engineer is also responsible for ensuring that a faulty product in no case leads to personal injury or even death, nor to the damage or destruction of property. The relevant safety regulations must always be observed. Dangerous faults must be recognized by additional measures and any consequences prevented. Consistent use of the diagnostic elements of the PCD, such as the watchdog, exception organization blocks (XOB) and test or diagnostic instructions shall be made.